

ST. ALBERT THE GREAT CATHOLIC COMMUNITY

Austin, Texas

New Church Building

RD Habiger & Associates Inc was hired, with Cotera, Kolar, Negrete Architects of Austin, Texas, to design this new 820 seat Catholic Church. A worship environment program was completed after a series of open parish meetings. This design participatory process included presentations from art, furnishings, music, landscape, building maintenance, and liturgy.

Creating an expansive entry plaza was critically important. The parish wanted to have a large, quiet, and lush area between the parking and main entrance. A covered walkway connects the drop-off to the entrance. A large gathering space and baptistry tower provide a transition experience from secular to sacred.

In the worship space the altar is the central focus. Seating slopes upward from the level floor around the altar so that the assembly can see the action of the liturgy and see each other. Ample space is at the altar for sacramental action. Shrines have been established at four corners of the worship space. A separate Blessed Sacrament Chapel is behind a magnificent 24'x24' stained glass wall. The tabernacle pillar uses the same Texas red granite as at the baptismal font.

The liturgical furnishings were jointly designed by Robert Habiger and crafts-artists hired to fabricate the furniture.

Dedicated: 1998
 Design Architect: Robert Habiger and Roger Kolar
 Architect of Record: Cotera, Kolar, Negrete Architects
 Liturgical Design Consultant: Robert Habiger
 Stained Glass Artist: Jeff Smith

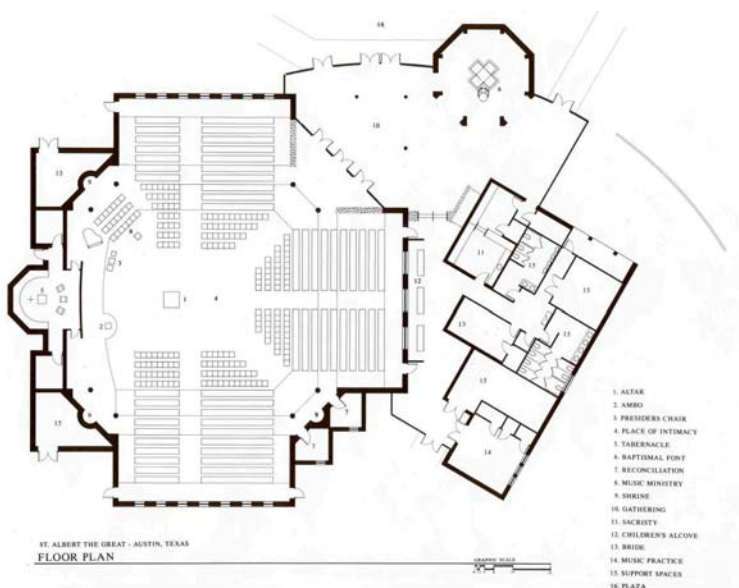

Awards:
 Stained Glass Window
 "Resurrection" by Jeff Smith of
 Architectural Stained Glass, Inc.
 - American Institute of
 Architects/ Interfaith Forum on
 Religion, Art, and Architecture -
 Religious Art Award - 2001